

INSTALLATION INSTRUCTION TWO HANDLES SHOWER MIXER

※ACCESSORIES CHECKING

LIST OF THE STANDARD ACCESSORIES:

Please double-check the accessory list hereafter and contact our company or our distributor for any unconformity.

Remarks:

1. Without affecting their performing, accessories may be changed without further notice.
2. Drawings for reference only, Product size & shape refer to actual faucet.

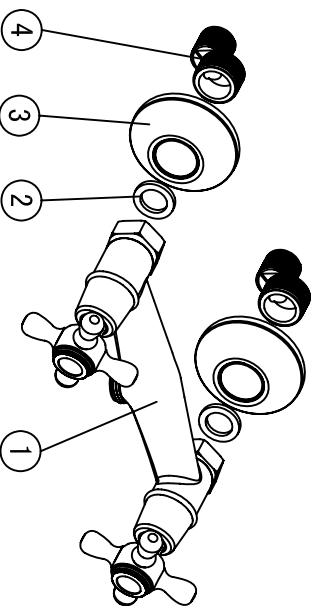

Code	The Accessory List	Quantity
1	Main body	1
2	O-ring	2
3	Flange	2
4	Eccentric nut	2

※Installation Instructions

- ☆ Do not disassemble the main body, as it has been installed & commissioned correctly & precisely before leaving the factory.
- ☆ To avoid the faucet from jamming, do flush the water pipe before installation.
- ☆ After installation, make sure every joint is safely sealed & no leaking.
- ☆ Using condition: Working pressure at 0.05-1.0MPa (including cold & hot water pressure), with applicable water temperature: 4°C-90°C.
- ☆ Make sure to connect the hot/cold inlet pipe correctly, if standing in front/hot water pipe connecting to the left & cold water pipe connecting to the right.

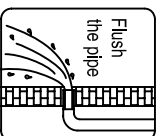
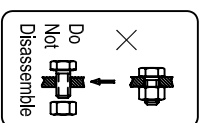

※Installation Procedures

☆ Please install the connection hose into the wall according to the installation Procedures.

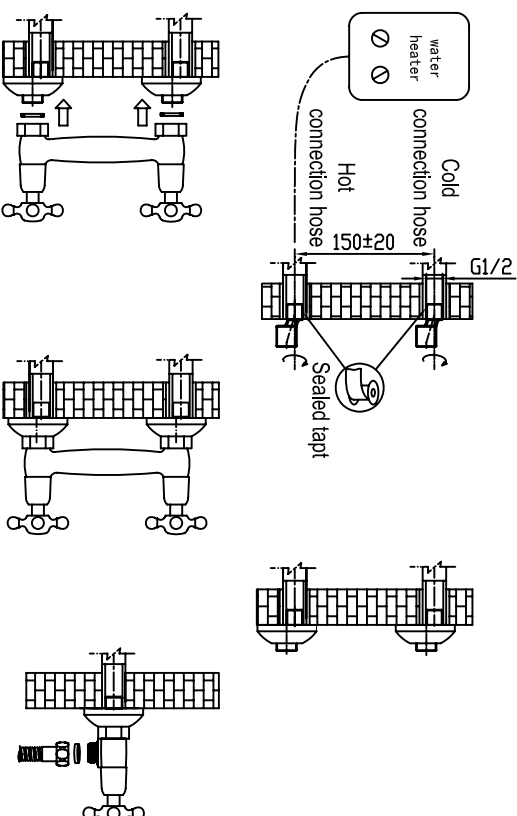

※Usage

☆ How to operate the handwheel

1. The left handwheel: To turn on the hot water directly. The largest rang is 90° and turn off rightabout.
2. The right handwheel: To turn on the cold water rightabout and turn off directly.

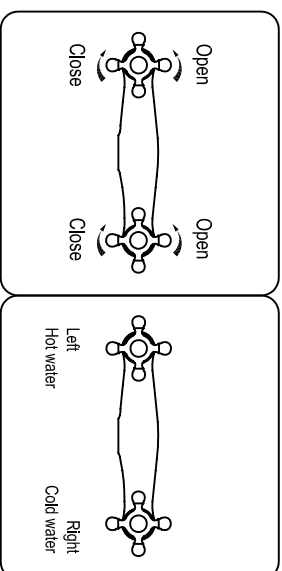

※Cleaning & Maintenance

☆ To keep the product clean & shining, follow the as below:

1. Flush with clean water & dry with soft cloth only.
2. If any dirt, clean with soft liquid or transparent glass detergent.
3. Do not use any scrubbing detergent, polish, same-cloth, paper tissue or scraper.
4. Do not use acid detergent, indissolvable grain-like detergent or soap.

